



DM-EP OTHER PRODUCTS

Cold Shrink End Caps

Features / Applications

DM-EP is a EPDM rubber cold shrink end caps which are factory expanded and slipped over onto a removable core. DM-EP offers a tight seal and a good mechanical protection for cable ends. No tools, mastics or tapes are required. Easy installation and dismantling. DM-EP is suitable for protect cables, pipes and other cylindrical objects from exposure to moisture, contamination, corrosion, ozone, ultra-violet radiation, physical contact and other environmental hazards. Both for open-air and underground application.

Characteristics

-40 °C to +150 °C

Ratio 2:1

EPDM rubber cold shrink end caps

Standard color: Black.

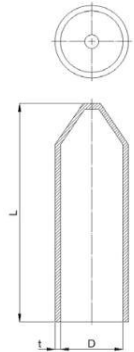

Technical data

Property	Values	Test Methods
Working temperature	-40°C to +150°C	-
Tensile strength	≥ 10 MPa	ASTM D 415-75
Elongation at break	≥ 600%	
Tear Strength	28,3 kN/m	ASTM D 624
Fungus Resistance	No Growth	ASTM G 21
Moisture Absorption	3.0% wt. Gain	ASTM D 792

Dimensions

Spec	As supplied (mm)	After recovery (mm)		Standard length
	Inside Diameter Min. (D)	Inside Diameter Max. (d)	Wall Thick-ness Min. (t)	(mm)
DM-EP- 20	φ20	12	2.5	70
DM-EP - 28	φ28	16	2.5	70
DM-EP - 47	φ47	23	2.6	70
DM-EP - 80	φ80	46	2.6	70